

# 2

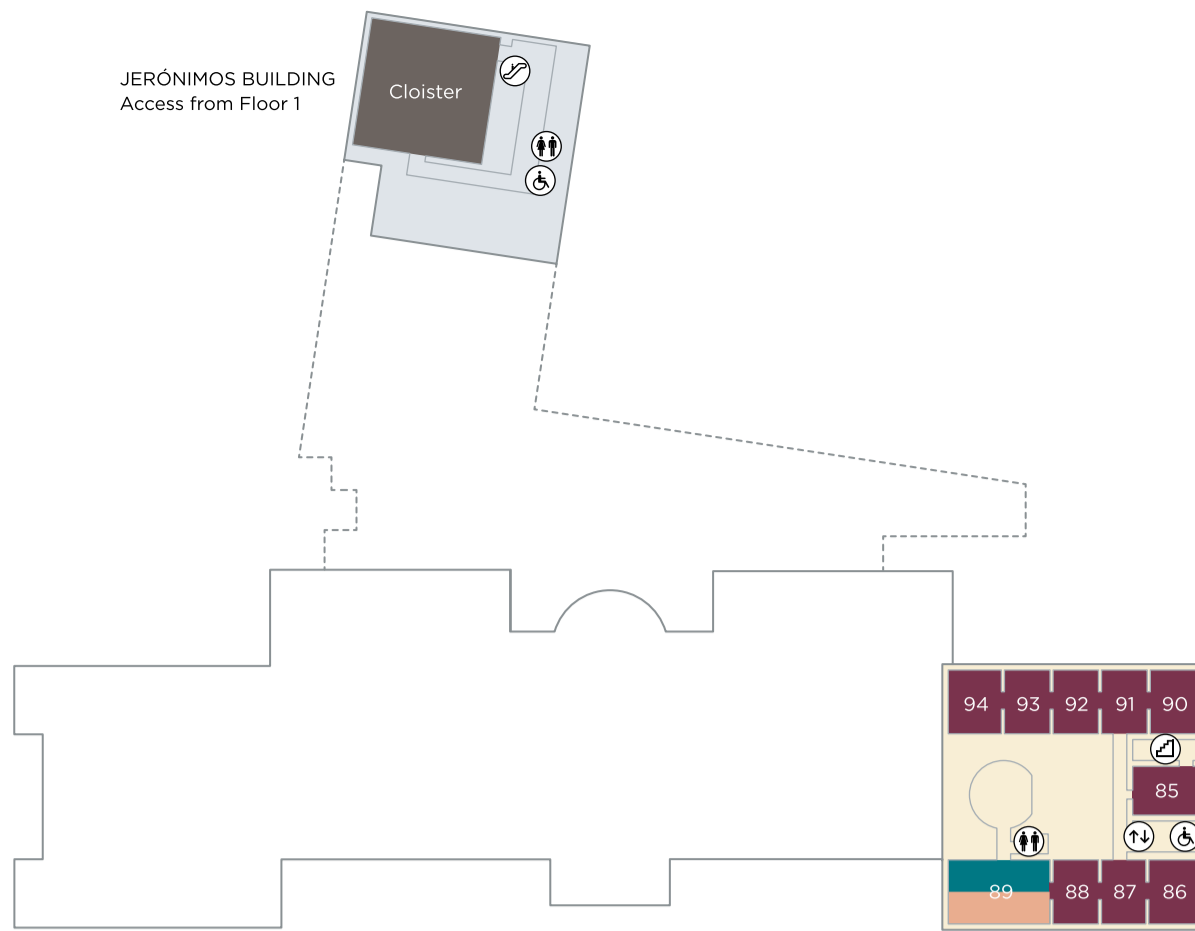

# 1

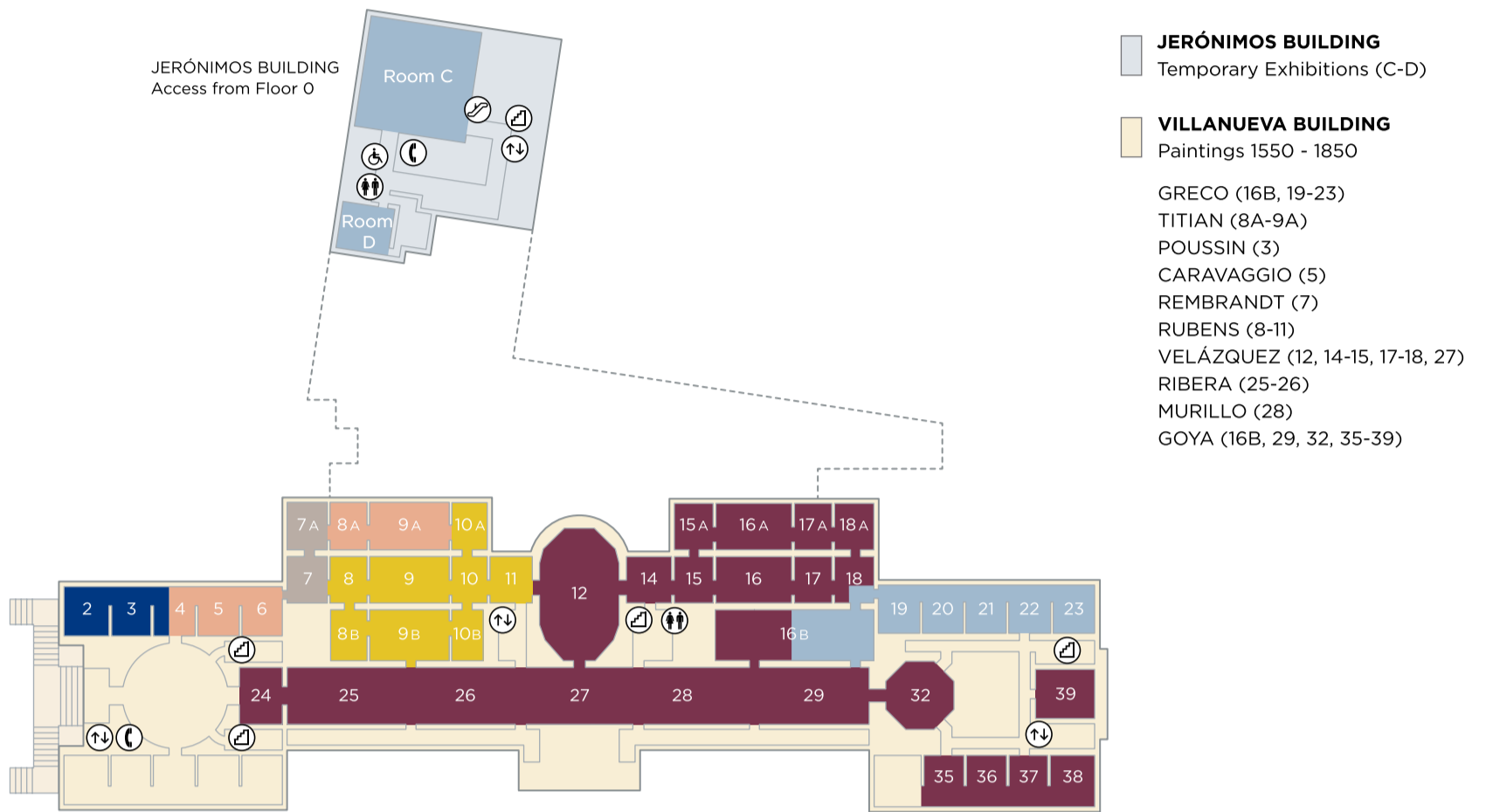

# 0



# -1

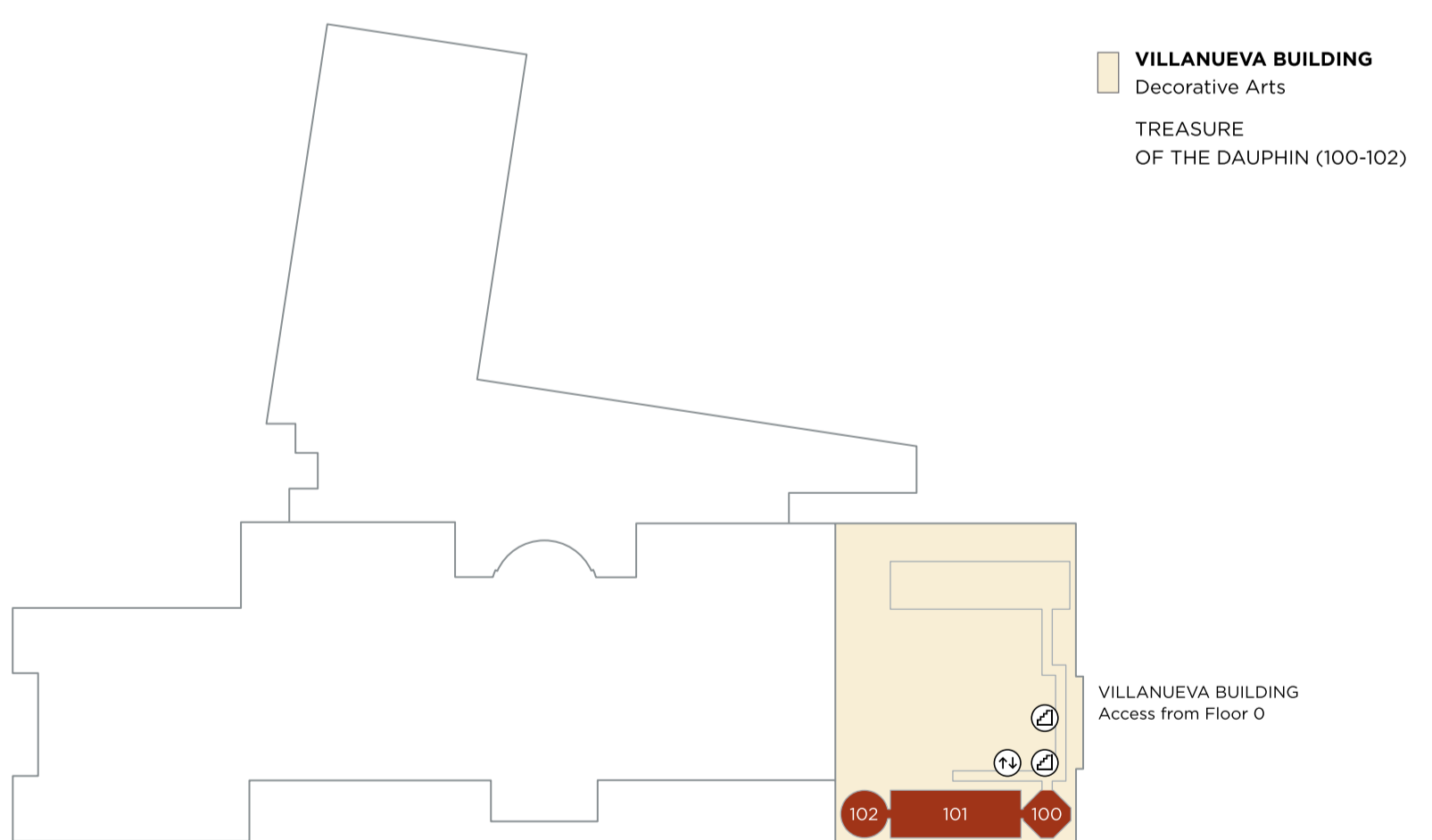

## FRENCH PAINTING 1600 - 1800

**FIRST AND SECOND FLOORS**  
CLAUDE (2)  
POUSSIN (3)

## DUTCH PAINTING 1600 - 1695

**FIRST FLOOR**  
REMBRANDT (7)

## ITALIAN PAINTING 1300 - 1800

**GROUND, FIRST AND SECOND FLOORS**  
TITIAN (8A-9A, 75)  
TINTORETTO (75)  
CARAVAGGIO (5)  
TIEPOLO (89)

## SCULPTURE

**FIRST AND SECOND FLOORS**  
CLASSICAL SCULPTURE (71-74)  
LEONI (CLOISTER)

## FLEMISH PAINTING 1430 - 1700

**GROUND AND FIRST FLOORS**  
VAN DER WEYDEN (58)  
BOSCH (56A)  
RUBENS (8-11)

## DECORATIVE ARTS

**BASEMENT**  
TREASURE OF THE DAUPHIN (100-102)

## GERMAN PAINTING 1530 - 1800

**GROUND AND SECOND FLOORS**  
DÜRER (55B)  
MENGS (89)

## SPANISH PAINTINGS 1100 - 1850

**GROUND, FIRST AND SECOND FLOORS**  
EL GRECO (16B, 19-23)  
VELÁZQUEZ (12, 14-15, 17-18, 27, 60-63)  
GOYA (16B, 29, 32, 35-39, 85, 90-94)

## TEMPORARY EXHIBITIONS

Please look at this map for more information on our temporary exhibitions



CCTV recording is controlled by the Prado Museum.  
For further information call + 34 902 10 70 77  
If you do not wish to keep this plan, please return it to the information desk for recycling.

Cloakroom

Lift

Escalator

Stairs

Toilets

Adapted Toilet

Baby Change

Information

Telephone

Audio Guide

Auditorium

Press Room

Cafe

Restaurant

Gift Shop

Book Shop

Rest Area

Friends of the Museum

Education

First Aid